

Property Exhibit

of

Lot 1 of Certified Survey Map No. 1758,
recorded in Vol. 8 of Certified Survey Maps of Walworth County
on Page 185, located in the Southwest 1/4 of Section 7, Town 3
North, Range 17 East, Town of LaFayette, Walworth County, Wisconsin.

Prepared for: Southern Lakes Evangelical Free Church
N6866 Highway 12 & 67
Elkhorn, Wisconsin 53121

Tax Parcel
GSC 1200008A

Tax Parcel
KLF 700004A

North 1028.00'

South 1031.73'

West line of the Southwest 1/4 of Section 7-3-17.

Centerline of Ditch

Lot 1
C.S.M. 1758
10.213 Acres
444,864 Sq. Ft.

Gravel
Parking
Lot

Shed

Church
N6866

West
86.00'

North 460.00'

East
121.00'

Tax Parcel
KLF 700004A

East
174.28'

North
120.00'

United States Highway 12 & State Trunk Highway 67

West 1/4 Corner
Section 7-3-17.

Southwest Corner
Section 7-3-17.

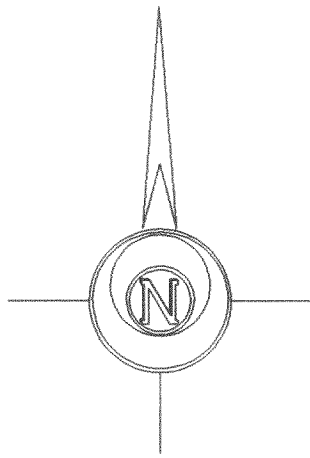

Bearings referenced to Certified
Survey Map No. 1758

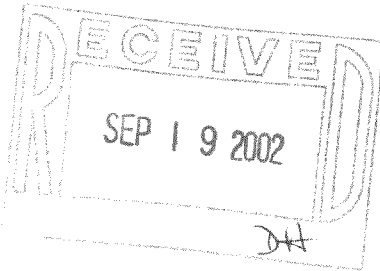
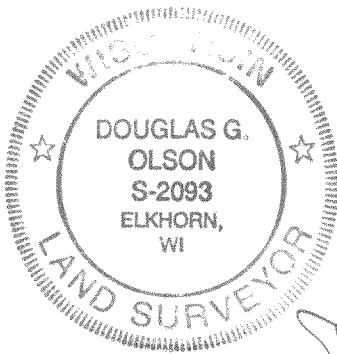

Copyright © 2002 by Jensen & Olson Land Surveying, LLC.
All rights reserved. No part of this survey plat may be reproduced
or transmitted in any form by any means - graphic, electronic, or
mechanical, including photocopying, tracing, or information storage
and retrieval systems - without permission in writing from Douglas
G. Olson, Jensen & Olson Land Surveying, LLC.

Sheet 1 of 1 Sheets.

Job Reference Number
2002.149

Legend

- Found County Section Corner
- Found Iron Pipe
- Recorded Information
- Concrete Cover
- PVC Pipe
- Light Pole
- Utility Pole
- Utility Pedestal
- Concrete Surface
- Asphalt Surface
- Gravel Surface



Jensen & Olson Land Surveying, LLC

45 South Wisconsin Street P.O. Box 322
Elkhorn, Wisconsin 53121
Telephone: (262) 723-3434
Facsimile: (262) 723-8044

Scale in Feet

1" = 60'



Survey date: August 14, 2002.
Revisions: